

**ECAS Controls**

You can use the memory buttons on the Electronically Controlled Air Suspension - ECAS - control unit to preset the chassis height at two different levels. Useful for coupling and uncoupling a semi-trailer or adjusting the body floor level to match different loading deck heights.

- ➔ Press the button (A) to activate the ECAS control
- ➔ Press up (B) or down (C) buttons as required to adjust the height of the chassis to the first setting
- ➔ To store a height setting, press the stop button and the memory button (M1) together
- ➔ Use M2 to store a second height setting if required
- ➔ Button (D) resets the chassis to normal ride height



**Third Axle Control Systems (6x2 models)**

On tractor units with three axles there are two control systems available:

- ➔ Traction control 
- ➔ Axle lift facility 

**'Traction Control'**

Increased traction is available by transferring weight to the drive axle. This can be used at low speed on slippery surfaces.

- ➔ Switch (A), to the left of the radio, provides extra traction by dumping the air from the lift axle. This only operates below 25 km/h

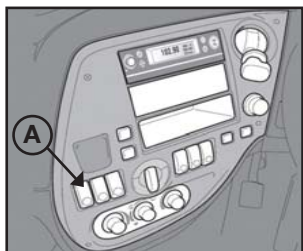

**'Axle Lift Facility'**

This can be used when the combination is running unladen or lightly laden to reduce tyre wear.

- ➔ Switch (B) raises the lift axle. When the load on the drive axle is 9 tonnes or more the axle is lowered automatically

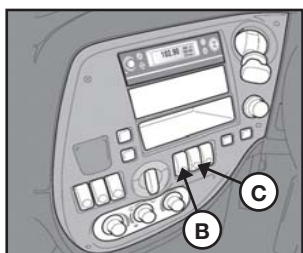

- ➔ Switch (C), immediately to the right of the radio, returns the suspension to normal ride height

**Driving for Economy**

To obtain the best fuel consumption, combined with the optimum performance, XF engines need to be operated within the green band.

- ➔ Driving up through the gears laden and on level ground; block change i.e. 2nd to 4th and subsequent full gears up to 7th and only from here use split gears
- ➔ XF engines develop maximum pulling power at low revs - don't drive by 'ear', watch the rev counter and keep the engine inside the green zone

**NOTE:** Don't allow the engine to over-rev into the red section. This can result in extra powertrain wear and possibly engine damage

**Effortless Driving**

Using the driving features wherever and whenever possible will help you have an easier day:

- ➔ Wherever practicable use Cruise Control - It's better for the truck and less effort is required by you.
- ➔ When descending a gradient use the exhaust/MX Engine Brake and select the gear to put the engine in the blue band. Remember this will increase the brake life and save fuel as the fuel is cut every time the exhaust/MX Engine Brake is engaged.
- ➔ The personal road speed limiter can be useful when driving in urban areas with speed restrictions which means the driver can now concentrate on the traffic with the safe knowledge the speed will not be exceeded.

**Important**

Your DAF XF is also supplied with a comprehensive Driver's Handbook. It is important that you take the time to read your copy and familiarise yourself with your vehicle and the features it offers. Make sure this Driver's Handbook is in the vehicle at all times. Read it carefully before making your first journey, especially the section; 'Warnings and Safety Instructions'

XF/0706/1000k

# DAF XF

## How to get the best out of your truck



The DAF XF Series has been designed for optimum efficiency, safety and comfort. The following tips will help you get to know your truck and ensure safe, easy and economic operation.

**Contents:**

**Pre-Trip Information:**

- ➔ Entering The Vehicle
- ➔ Getting Comfortable
- ➔ Driver Information Panel (DIP)
- ➔ Oil Level Check
- ➔ Engine Start-Up

**Driving Systems:**

- ➔ Exhaust/MX Engine Brake
- ➔ Downhill Speed Control
- ➔ Cruise Control
- ➔ Personal Speed Limiter Settings
- ➔ Adjustable Intermittent Wipe

**Suspension Systems:**

- ➔ ECAS Controls - Memory Settings
- ➔ Third Axle Control Systems (6x2 models)

**Driving Hints & Tips**

- ➔ Driving for Economy
- ➔ Effortless Driving

### Entering The Vehicle

There are two types of door lock controls available - central locking by key or remote locking by a hand-held transmitter.

- ➔ For security, the passenger door is not unlocked. To unlock the passenger door, either use the key in the passenger door or press button (A) on the central dash panel

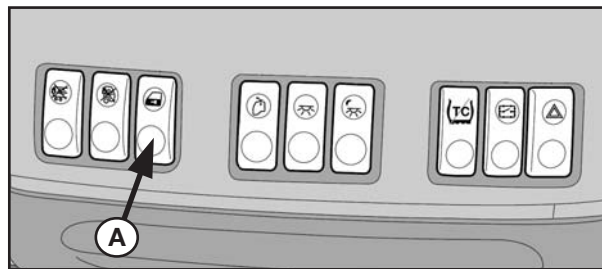

**NOTE:** Using the remote locks the passenger door BUT does not unlock it.

### Seat and Squab Adjustment

In addition to the normal range of adjustments, the driver's seat has a separate squab forwards and backwards adjustment. This is useful for drivers who are particularly long in the leg.

- ➔ The squab can be adjusted independently by lifting button (2) in the centre of the squab
- ➔ Lift lever (1) to adjust forward/back position of the whole seat

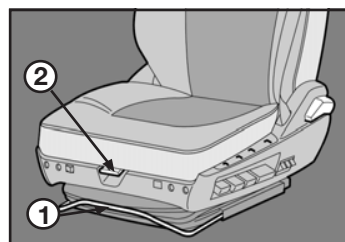

### Driver's Air Seat (where fitted) - Entry/Exit

The foremost button on the seat (3) allows easy entry and exit from the cab.

- ➔ On exit from the cab, pushing the button down will drop the seat to its lowest position
- ➔ Pulling the button up will reset the seat to the last seat height position

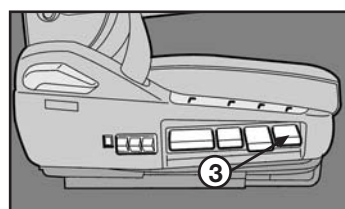

### Steering Column Adjustment

The steering wheel can be adjusted for height and reach.

- ➔ To adjust the position, lift the toggle switch (A). This unlocks the steering column for adjustment for 20 - 30 seconds. Push down to lock

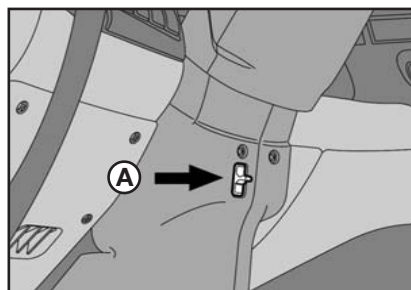

### Driver Information Panel (DIP)

The Driver Information Panel provides information about vital vehicle and engine functions and is part of the central warning system. When the ignition is turned on, the following warning signals will be displayed:

- ➔ Oil pressure - red
- ➔ Alternator voltage - red
- ➔ EBS prime mover - red
- ➔ EBS prime mover - yellow
- ➔ VSC - yellow
- ➔ AIRBAG - yellow

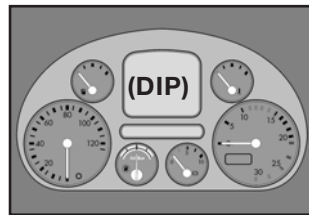

If a fault is detected then a warning will be displayed:

- ➔ A red 'STOP' warning indicates a serious fault and the vehicle must be stopped safely and the engine switched off
- ➔ A yellow indicator is less serious but should be investigated at the earliest opportunity

To access further information, press button (A) to activate the DIP. Turning the button left or right will scroll through each feature on the menu. Press button (A) a second time to execute the menu item.

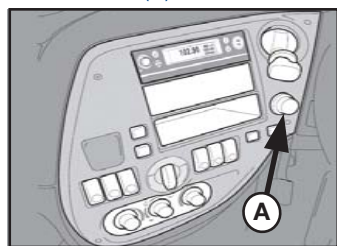

The DIP provides the following information:

- ➔ Vehicle Info
- ➔ Service Info
- ➔ Trip Info
- ➔ Settings

### Oil Level Check

The oil level check on the DIP provides three level marks:

- ➔ Maximum oil level
- ➔ Oil can level
- ➔ Low oil level

It is recommended that the oil is only topped up when the level indicator reaches the 'oil can' mark. At this mark, top up using 3 litres of oil.

### AdBlue

There is an AdBlue level gauge in the main dash. A warning will also be displayed in the DIP if the tank level drops to a minimum level.

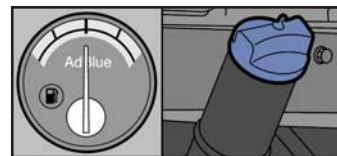

### Engine Start-up

The engine management system automatically controls the amount of fuel and 'intake air heating' required.

- ➔ When you start the engine do not touch the throttle pedal

### Exhaust Brake and MX Engine Braking System

Using the Exhaust Brake/MX Engine Brake increases service brake life and saves fuel. There are two options of use:

- ➔ Press and hold down the button on the 'footrest'
- ➔ Move the control (on the R/H stalk) down to the 'ON' position and release. To turn off the system briefly move the lever up to 'OFF'.

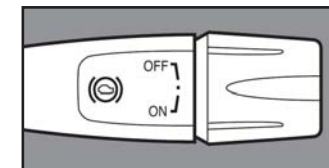
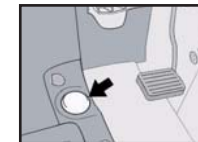

The Exhaust/MX Engine braking system works most effectively when the engine revs are in the blue section of the rev counter.

- ➔ With a manual gearbox, change gear to ensure the engine speed stays in this range

### Downhill Speed Control

The Downhill Speed Control keeps the desired vehicle speed at a constant level during descent by using the 'retarder'.

- ➔ To set the Downhill Speed Control, ensure that the vehicle is running at the required speed and in excess of 30 km/h
- ➔ Press 'SET' (1) to activate

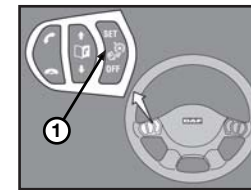

The system will be de-activated by:

- ➔ Pressing 'OFF' (1)
- ➔ The cruise is set at a higher speed
- ➔ The throttle pedal is operated.

### Cruise Control (RH Stalk)

To set the cruise control, ensure that the vehicle is running at the required speed (in excess of 30 km/h).

- ➔ Lift the control lever up firmly towards the steering wheel to set the cruise speed
- ➔ If you want to increase the set speed, lift the lever up and hold until the desired speed is achieved
- ➔ To decrease the set speed, press the lever down and hold until the lower speed is reached

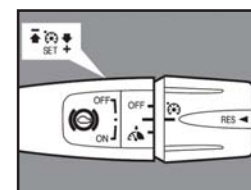

When the cruise speed is set, a speedo icon and the speed are displayed on the Driver Information Panel.

- ➔ To reset cruise control to the last speed setting, press the button on the end of the lever firmly and release
- ➔ To manually deactivate cruise control, turn the control to the 'OFF' position and release

Cruise control will also be deactivated:

- ➔ By operating the clutch, service brake or exhaust/MX Engine Brake
- ➔ If the variable personal speed limiter is activated

### Cruise Control (Steering Wheel)

To set the cruise control, ensure that the vehicle is running at the required speed and in excess of 30 km/h.

- ➔ Press 'SET + or -' (1) Cruise is now set
- ➔ Press '+' or '-' (1) to increase or decrease the set speed
- ➔ Resuming the cruise control to the last setting by pressing 'RES' (2)

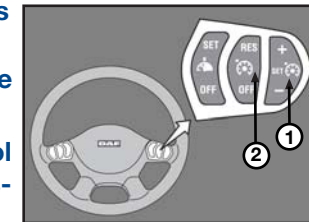

When the cruise speed is set, a speedo icon and the speed are displayed on the Driver Information Panel.

- ➔ To manually deactivate cruise control, press 'OFF' (2)

Cruise control will also be deactivated:

- ➔ By operating the clutch, service brake or exhaust/MX Engine Brake
- ➔ If the variable personal speed limiter is activated

### Personal Speed Limiter (RH Stalk)

The Personal Speed Limiter, when activated, sets the vehicle speed limit:

- ➔ Adjust the vehicle's speed to the limit required
- ➔ Twist the switch on the RH stalk down to the Limiter (1) position. The speed limit will be indicated on the DIP
- ➔ To cancel the set limiter speed, turn the switch to the 'OFF' position

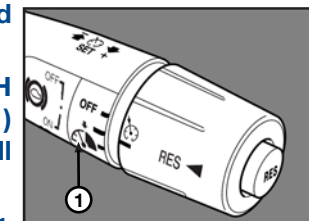

### Personal Speed Limiter (Steering Wheel)

- ➔ Adjust the vehicle's speed to the limit required
- ➔ Press 'SET' (3). The speed limit will be indicated on the DIP
- ➔ To cancel the limiter, press 'OFF' (3)

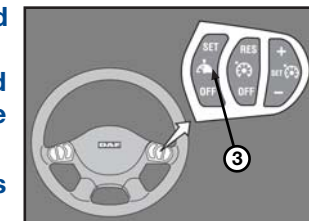

### Adjustable Intermittent Wipe

To adjust the intermittent wipe interval:

- ➔ Turn the switch (L/H Stalk) on and then off immediately
- ➔ When the screen requires wiping, turn on the switch again
- ➔ The elapsed time will now be stored in the memory

